

INSTRUCTIONS FOR USE

Please read the instructions for use before using PHALLOSAN® plus.

This is an additional set for PHALLOSAN® forte and can only be used in combination with the package PHALLOSAN® forte!
For instructions to PHALLOSAN® forte please visit www.phallosan.info

Package contents PHALLOSAN® plus:

- The Adapter Leverage
 - » applicable for every bell size
 - » flexible move
 - » safety clip
 - » easyremoving
 - » patent
- The Rod System with White Base Ring
 - » to be extended for every penis size
 - » optimal tension
 - » optional high a comfort force
- Protector Cap
 - » a pressure suit for the glans area
 - » higher results through
 - » more Force
 - » more safety
 - » higher Performance

Package contents PHALLOSAN® forte:

- Hard Plastic Bell with attached Sleeve Condoms
 - » up to 4 sizes for every manhood
 - » transparent safety
 - » optional mid-size (large bell-medium sleeve)
 - » anti-allergic material
 - » 3 valve system
 - » comfort meets effectivity
- Integrated Vacuum Pump
 - » creates micro vacuum
 - » no harm to tissues/spongy bodies/veins
 - » better result
 - » maximum output



Preparation:

1. Selection of the suction cup / sleeve (from PHALLOSAN® forte package)

Choose the correct Hard Plastic Bell and sleeve condom size using the measuring template. Pull the flaccid penis away from your body and take measurement on the penis shaft.

Attach the Vacuum Pump on the hard Plastic Bell; it only engages into the position with the arrow symbol (↕). Turn it to the pump symbol (⊕).

Roll the sleeve condom above the hard plastic Bell. When attaching the sleeve to the cup, please take care that the thick part (the groove) of the sleeve is positioned exactly on the edge of the hard plastic bell.

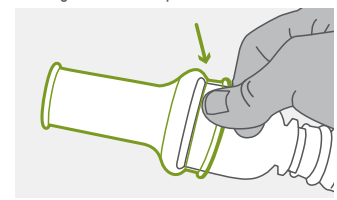

If the sleeve is pulled too far over the edge of the cup, the sleeve can be damaged.

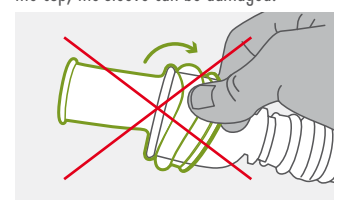

Carefully roll the sleeve to the edge of the suction cup until you have 1 cm space between the rolled up sleeve and the edge of the suction cup.

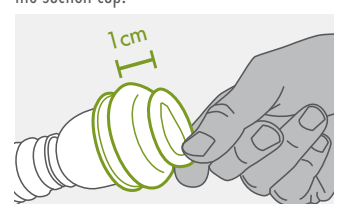

Now you can easily pull the rolled up sleeve behind the bead of the suction cup. Put the suction cup and rolled sleeve to the side and go to the next step.

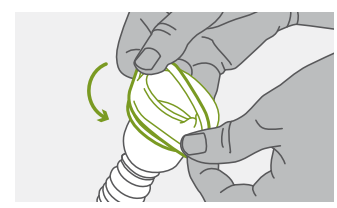

2. Protector cap

Pull the protector cap apart using both hands and slip it over the glans area. It should fit cozy but tight.

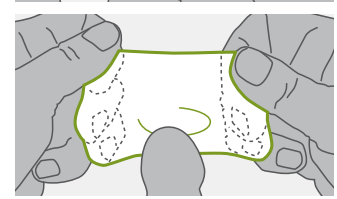
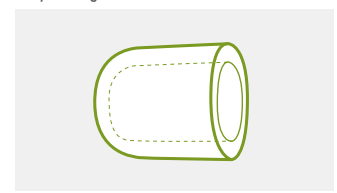

After placing the protector cap, it is important to make sure that as little air as possible remains at the tip of the glans.

Now put the complete Hard Plastic Bell/Sleeve/Pump aside.

3. Rod System

Take the Rod System and hold the White Base ring right next to your Penis Root. Extend or minimize the rods so they are 5 cm (2 inch) longer than the flaccid Penis.

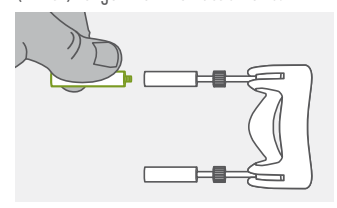

Place the white base ring above your penis (best while sitting). Attach the adapter Leverage to the end of the Rods.

Application:

1. Now, take the already Prepared Hard Plastic Bell/Sleeve/Pump. Place the Glans area half way into the Bell and Roll the sleeve condom off as far as you like.

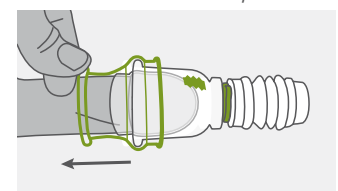

2. Press the pump 3-5 times and turn the green valve to the Lock Symbol.

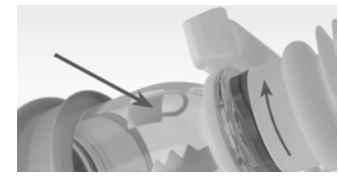

3. Lastly you press the Rods with the Adapter Leverage down and the C clip on to the hard plastic bell and let go.

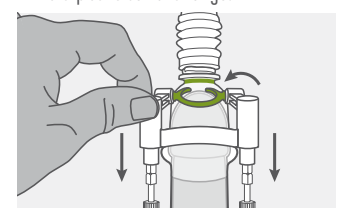

4. You should feel and see that the Penis is now being stretched.

Important: it is not about the high force but continuity to achieve the highest output.

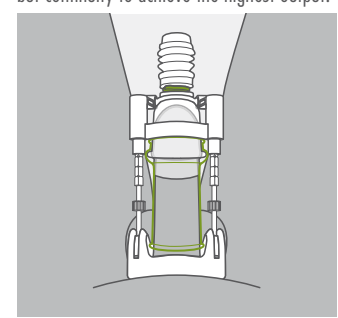

You have now the perfect combination of traction. No matter for what purpose:

Penis Extension:

Use Adapter Leverage for at least 6 hours a day, 5 days a week.

It is not about a high Force, it depends on the continuity to achieve a Cell Stimulation.

Through this, new cells will be implanted and a possible increase in length of 1.9 inch and 1.1 inch in girth can be achieved.

Erectile Dysfunction:

5 hours, 3 Days a week will achieve a much higher Blood circulation and therefore stimulates your Prostate and sexual desire.

The spongy bodies will be able to capture more blood and therefore erections will come more frequently and be more durable.

IPP/Penis Curvature:

IPP/Penis Curvature can be healed with the combination of Phallosan forte and the Adapter leverage. Important: use Phallosan forte for 4 days a week and the Adapter leverage for 2 days to straighten the curve.

The curvature will be completely straightened as new cells are implanted into the scar tissue around the bended area. Through this the penis will be completely straightened.

How to remove PHALLOSAN® plus:

First, please turn the green valve of the suction ball to the arrow symbol. The vacuum escapes. Please roll the sleeve carefully back towards the hard plastic cup and remove the complete suction device. **Do not stretch the sleeve with you fingers as it will otherwise rip immediately.** It will be easily removed when simply rolling the sleeve upwards.

Hotline:

E-Mail: service@swissana.com
For more information:
www.phallosan.info

Your PHALLOSAN® forte team